

- ① EXISTING PIER FOUNDATION
- ② O.G. VARIES FIELD VERIFY

SECTION A-A 1
Scale: 3/4" = 1'-0" S4

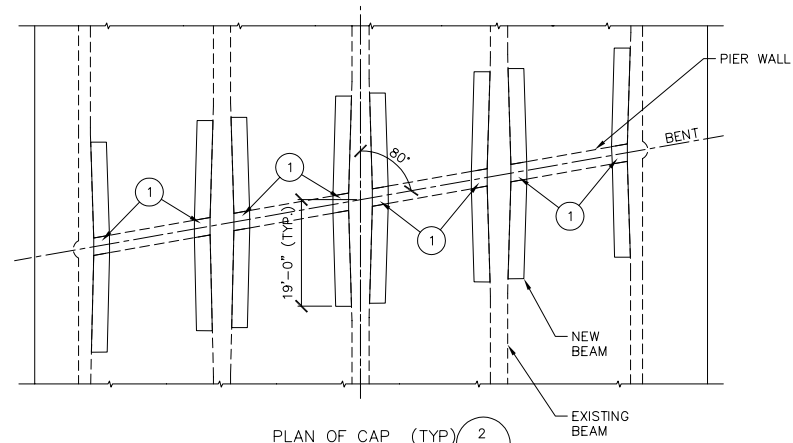

PLAN OF CAP (TYP) 2
Scale: 1/4" = 1'-0" S4

① REMOVE PIER CONCRETE TO CONSTRUCT NEW CONCRETE BEAM. PRESERVE & PROTECT EXISTING REBAR. DAMAGED BARS SHALL BE REPLACED AS DIRECTED BY ENGINEER

- NOTE:
1. SEE CIVIL PLANS FOR EXISTING GRADE
 2. PREVIOUS RETROFIT WORKS NOT SHOWN. SEE AS-BUILT PLANS FOR DETAILS
 3. THE CONTRACTOR SHALL VERIFY ALL CONTROLLING FIELD DIMENSIONS BEFORE ORDERING OR FABRICATING ANY MATERIALS

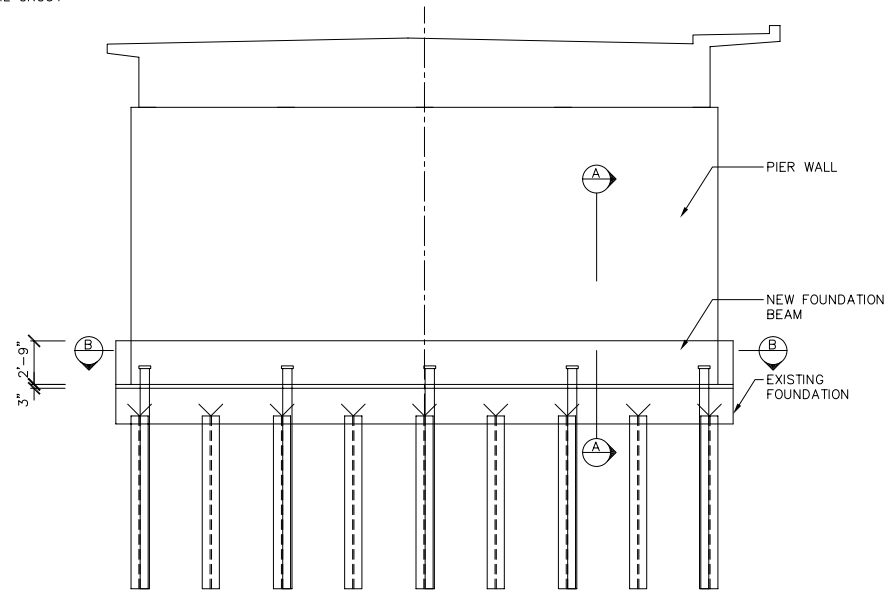

ELEVATION 4
Scale: 1/4" = 1'-0" S4

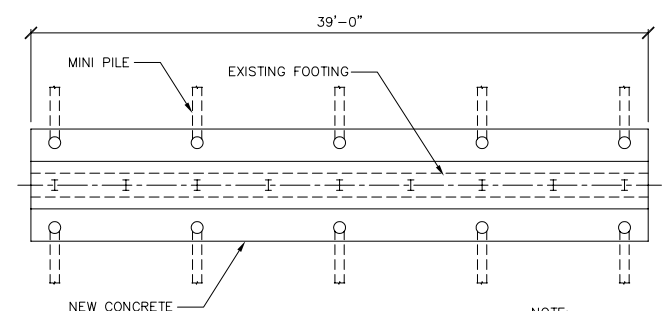

SECTION B-B 3
Scale: 1/4" = 1'-0" S4

NOTE: FOUNDATION SKEW NOT SHOWN

MISC. DECK AND FOUNDATION DETAILS AT PIERS
RETROFIT AND CAPACITY IMPROVEMENT OF 13th STREET BRIDGE